



# Roller Shade - Motorized Sunscreen

## Recharging Instructions

Thank you for your continuing support of Off Cut Shades. Please note that occasional charging (every 2-6 months) will be required for motorized **Sunscreen** shades. See instructions below.

### option 1

## CHARGING AT SHADE LOCATION

If you are able to locate a power outlet near the motorized Sunscreen, simply plug the charging cable into the motor head. The motor head will either have a recessed charging port (figure A), or a charging dongle (figures B or C)



Figure A

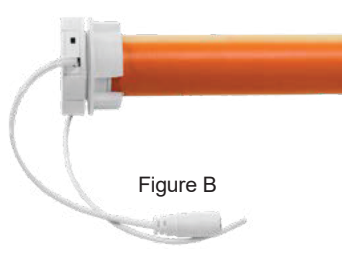

Figure B

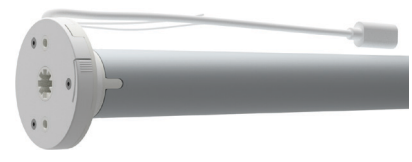

Figure C

### option 2

## REMOVE SHADE TO CHARGE

If you cannot reach the shade with the charging cable, follow these steps to remove the shade to bring it to your power source. Before you begin please ensure the the shade is fully rolled up.

### Step 1: Remove the fascia

1. Pull the bottom of the fascia down and toward you to unhook the bottom clasp
2. Lift the fascia up to unhook the fascia from the top clasp

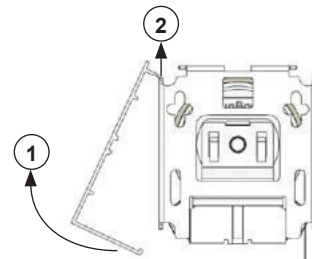

### Step 2: Remove the shade

Grip the shade roll near both ends, unhook the motor head side of the shade from the fascia bracket by lifting the roller shade up. Push the shade toward the pin end, move the motor head side of the shade down and the shade will come out easily. Bring the shade to your charging location to plug in as described under option 1.

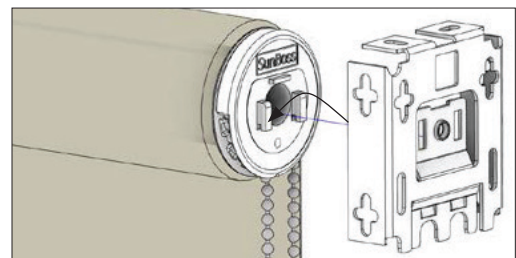

### Step 3: Reinstall the Shade

First, put the spring loaded Pin End into the hole in the bracket. Keeping gentle pressure against the pin end lift the motor head end up and align the two hooks on the motor head with the two slots in the bracket. The hooks should fall into place in the bracket, pull down gently to secure the blind into the bracket.

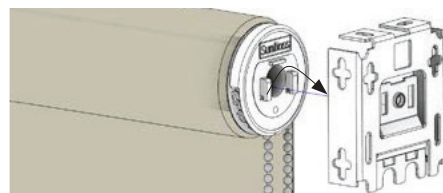
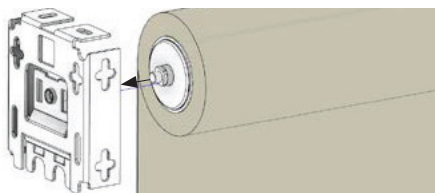

## Step 4 (if required): Adjust Upper and Lower Limit Settings

If the upper and lower limits of the shade were affected during removal and reinstallation, use these steps to correct the limits. Ensure you complete the following steps within 2 minutes or this process will have to be restarted.

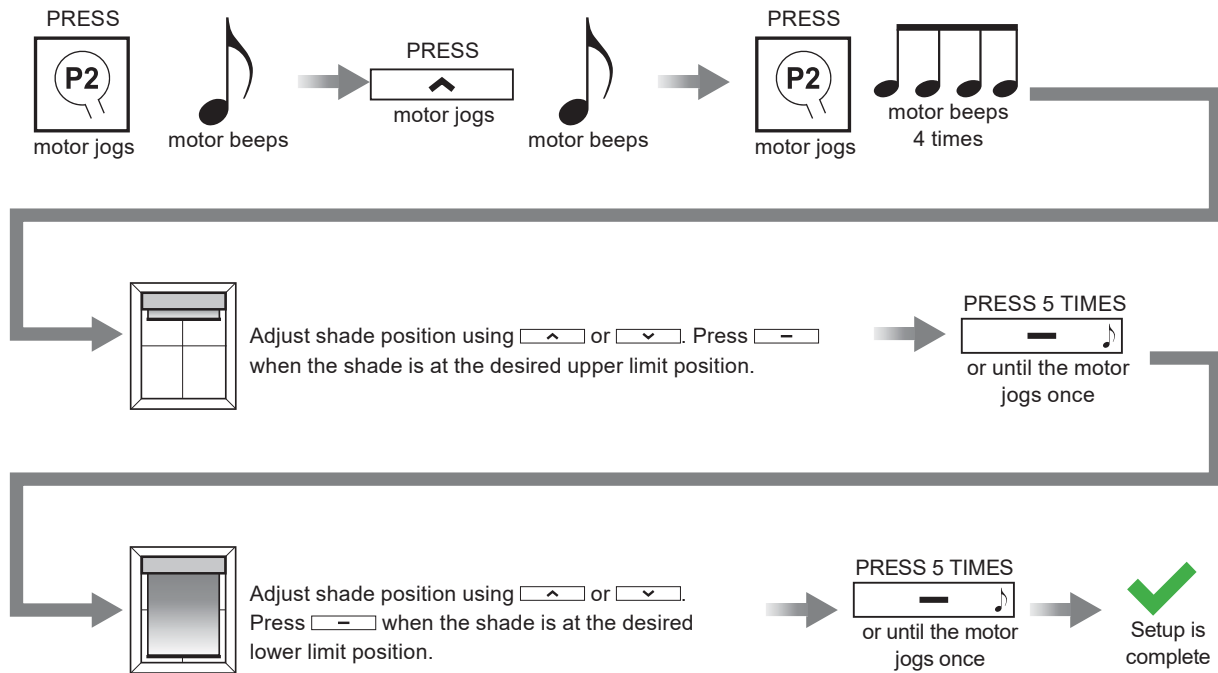

## Button Legend

### Remote front



Up button



Stop button



Down button



Channel selection

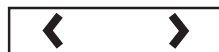

### Remote back



Remove back cover to access P2 button

P2