



Roller Shade - Motorized Sunscreen

Recharging Instructions

Thank you for your continuing support of Off Cut Shades. Please note that occasional (2-6 months) charging will be required for motorized **Sunscreen** shades. In the event that the motor battery is depleted between maintenance visits, we have provided you with a charger to be used. See instructions below for use.

option 1

CHARGING AT SHADE LOCATION

If you are able to locate a power outlet near the motorized Sunscreen, simply plug the charging cable into the motor head. The motor head will either have a recessed charging port (figure A), or a charging dongle (figure B)

Figure A



Figure B



option 2

REMOVE SHADE TO CHARGE

If you cannot reach the shade with the charging cable, follow these steps to remove the shade to bring it to your power source. Before you begin please ensure the shade is fully rolled up.

Step 1: Remove the fascia

- ① Pull the bottom of the fascia down and toward you to unhook the bottom clasp
- ② Lift the fascia up to unhook the fascia from the top clasp

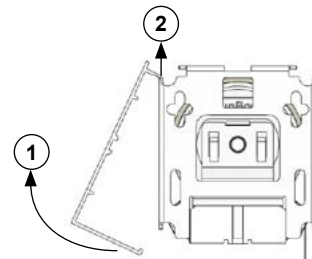

Step 2: Remove the shade

Grip the shade roll near both ends, unhook the motor head side of the shade from the fascia bracket by lifting the roller shade up. Push the shade toward the pin end, move the motor head side of the shade down and the shade will come out easily. Bring the shade to your charging location to plug in as described under option 1.

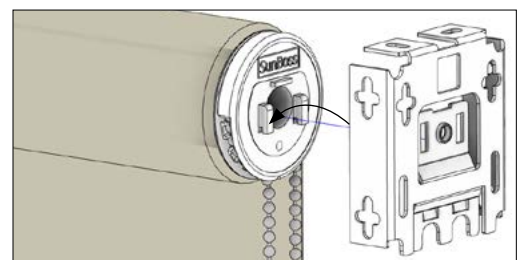

Step 3: Reinstall the Shade

First, put the spring loaded Pin End into the hole in the bracket. Keeping gentle pressure against the pin end lift the motor head end up and align the two hooks on the motor head with the two slots in the bracket. The hooks should fall into place in the bracket, pull down gently to secure the blind into the bracket.

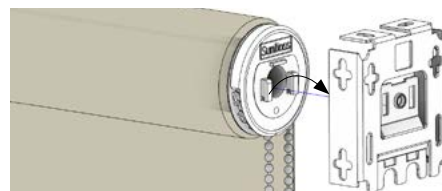
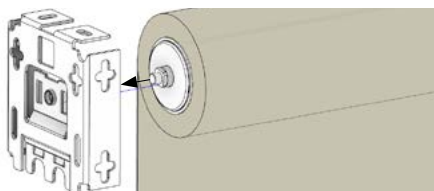

Step 4 (if required): Adjust Upper and Lower Limit Settings

If the upper and lower limits of the shade were affected during removal and reinstallation, use these steps to correct the limits. Ensure you complete the following steps within 2 minutes or this process will have to be restarted.

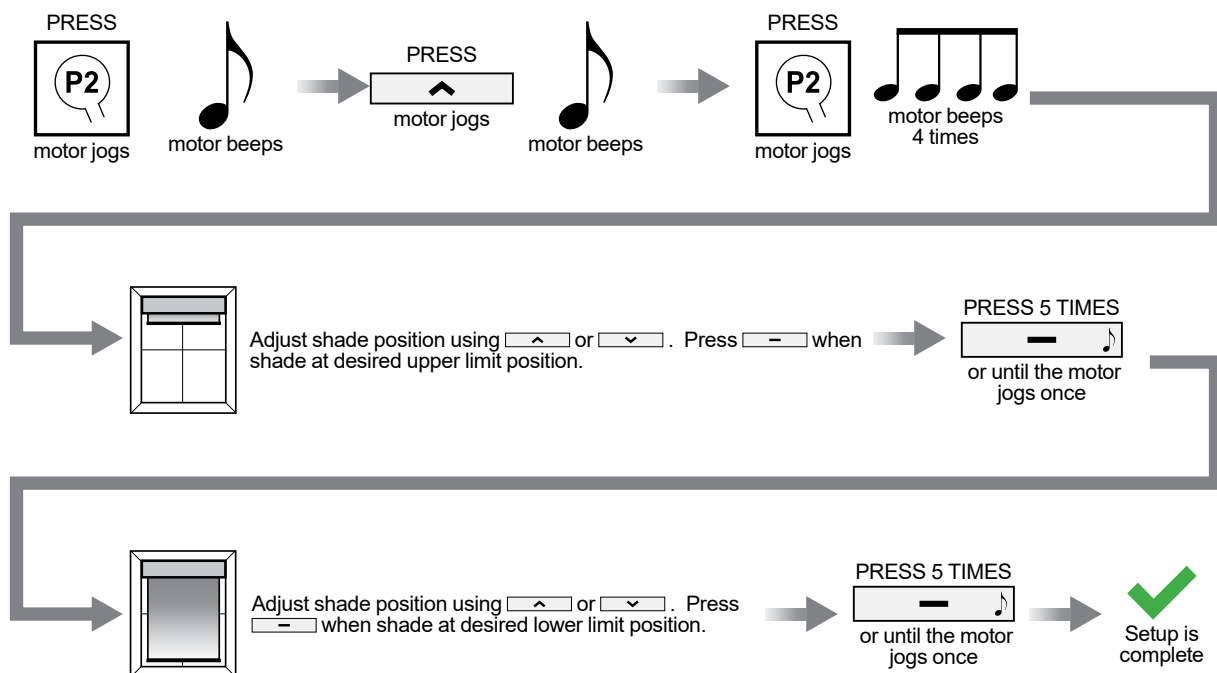

Button Legend

Remote front / Commande avant



Up button /
Bouton haut



Stop button /
Bouton d'arrêt



Down button /
Bouton bas



Channel selection /
Sélection de canal



Remote back / Commande arrière



Remove back
cover to access
P2 button.

Retirer le
couvercle arrière
pour accéder au
bouton P2.

