

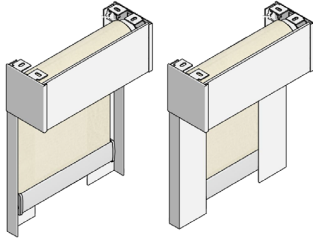

L Channel

Installation Instructions



NOTE:

L Side and Bottom Channels can be installed either in front or behind of the shade

- 1** Place the first channel in position. If bottom channel is also being installed, ensure to leave a $\frac{1}{8}$ " gap between the side channels and bottom of the frame.

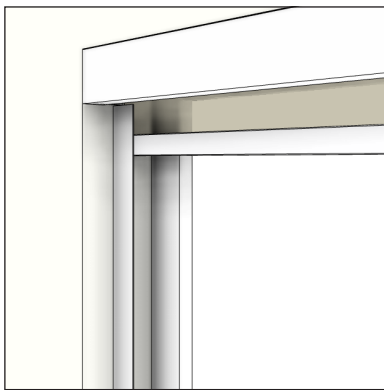

- 2** Mount the channel using the pre-drilled holes

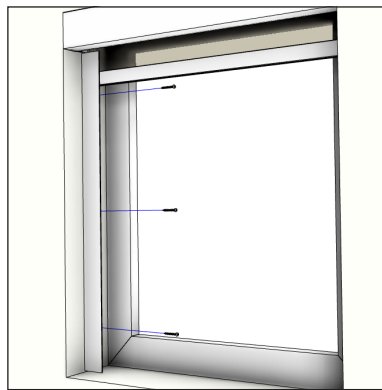

- 3** Place and mount the other side channel

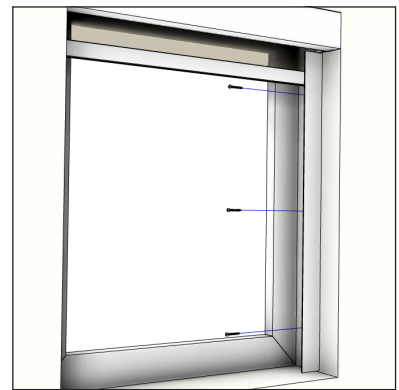

- 4** If using bottom channel slide it under the side channels and place it for installation

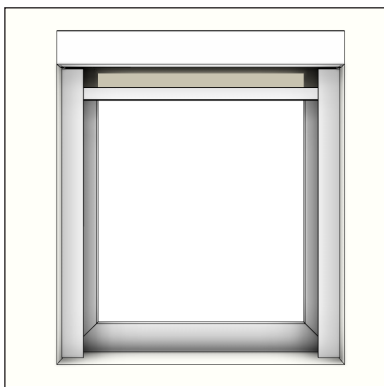

- 5** If using bottom channel mount it using the pre-drilled holes

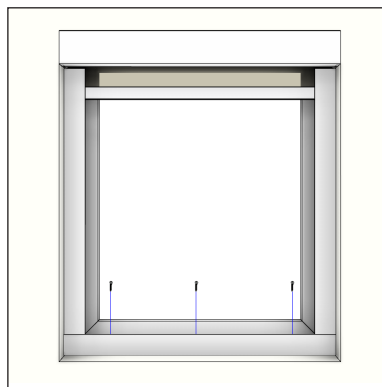

- 6** Installation complete

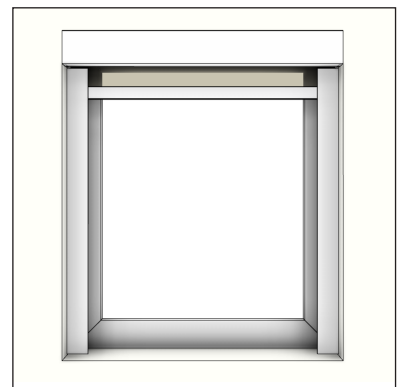

Canal en L

Instructions d'installation des rails latéraux et inférieurs

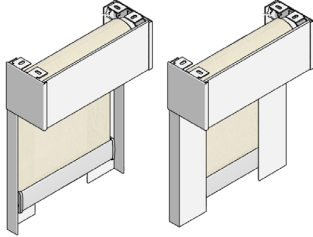

REMARQUE :

Les rails latéraux et inférieurs peuvent être installés devant ou derrière le store. devant ou derrière le store

- 1** Placez le premier rail en position. Si le rail inférieur est également installé, veillez à laisser un espace de $\frac{1}{8}$ " entre les rails latéraux et le bas du cadre.

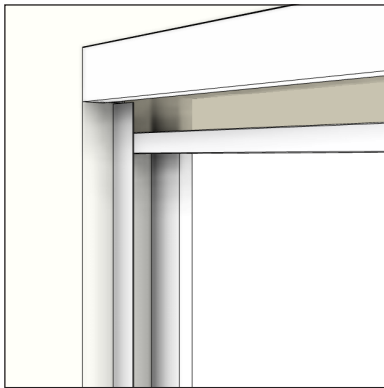

- 2** Monter le canal à l'aide des trous pré-perçés

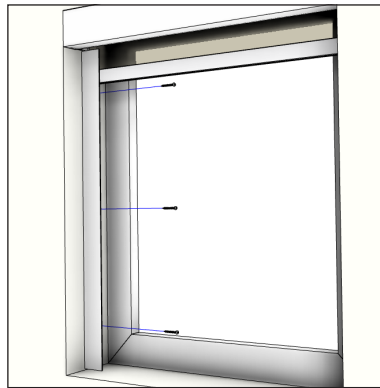

- 3** Placer et monter l'autre canal latéral

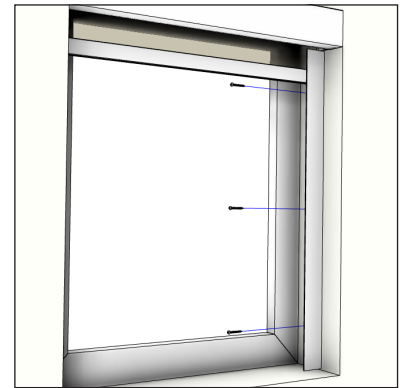

- 4** Si vous utilisez le canal inférieur, faites-le glisser sous les canaux latéraux et placez-le pour l'installation.

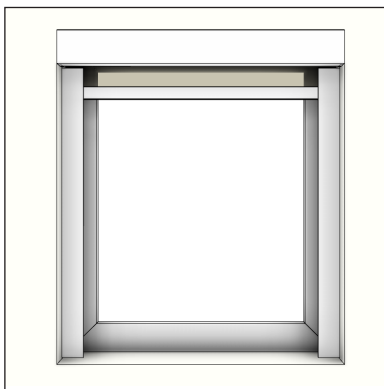

- 5** Si vous utilisez un rail inférieur, montez-le en utilisant les trous pré-perçés.

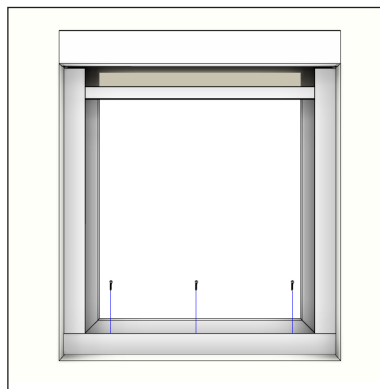

- 6** L'installation est terminée

