



Nimbus Motorized Skylight Shade

Installation Instructions

Please read all instructions fully before starting the installation.

ATTENTION: SPRING BOX IS UNDER CONSTANT TENSION. HANDLE WITH CARE.

NOTE: Nimbus should be installed into a flat and even window frame. Any warping or distortion of the window frame will interfere with the operation of the system, hence on-site adjustments such as shimming may be required.

SYSTEM COMPONENTS

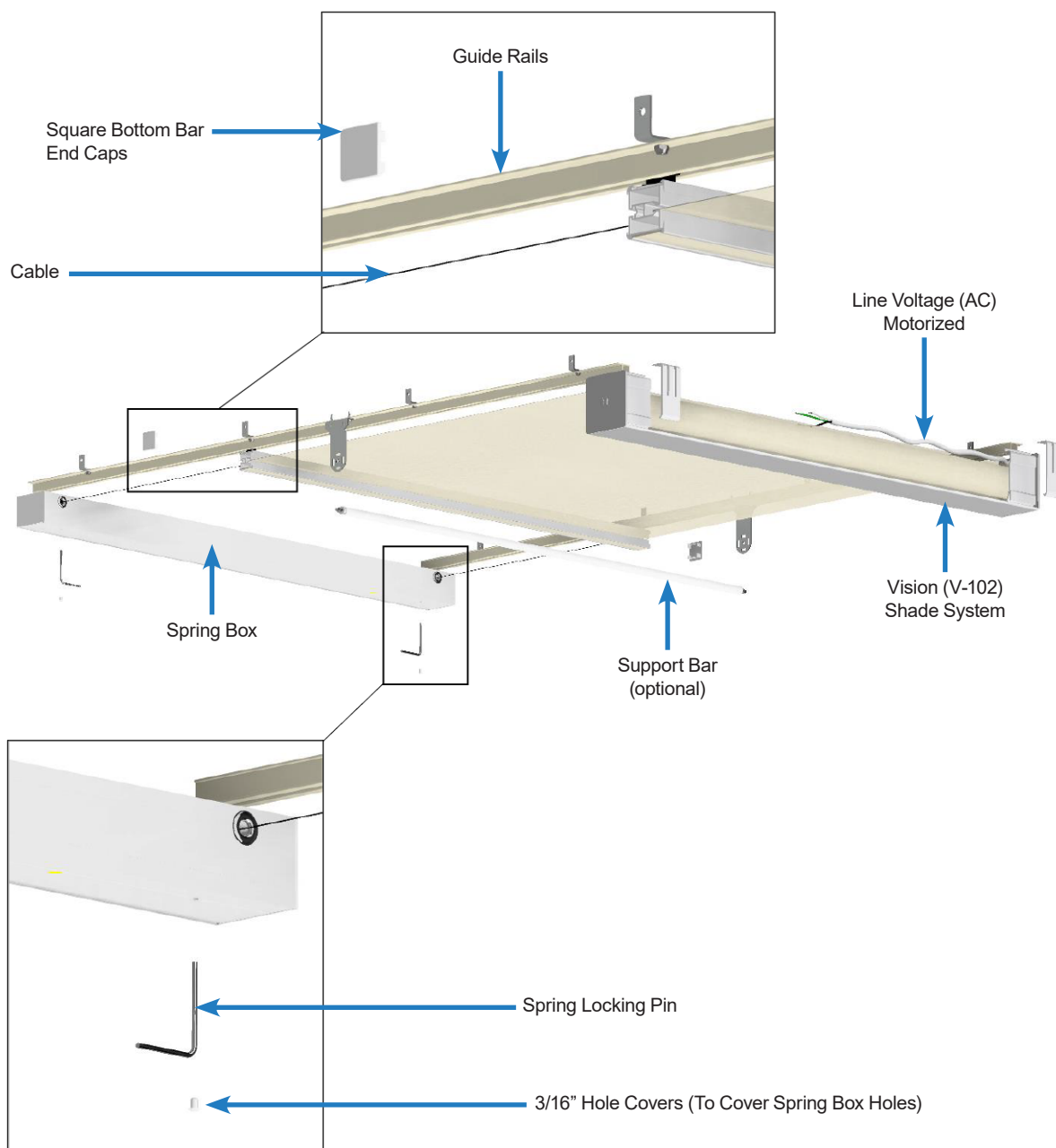

1

INSTALLING THE VISION V-102 SYSTEM

Unwrap the packaged Vision (V-102) roller shade system. The front of the Vision cassette should be facing down and parallel with the skylight window frame

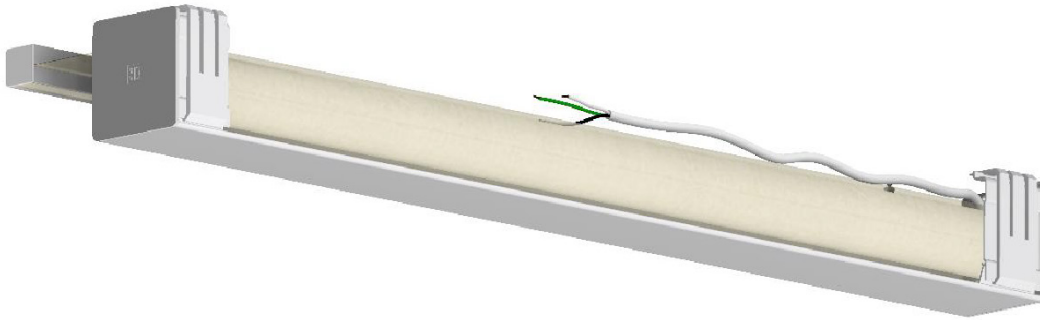

It is important that the brackets be securely mounted, level, and aligned to each other. Attach each bracket using two #8x1.5" Pan Head Zinc Screws included or equivalent, depending on the site conditions.

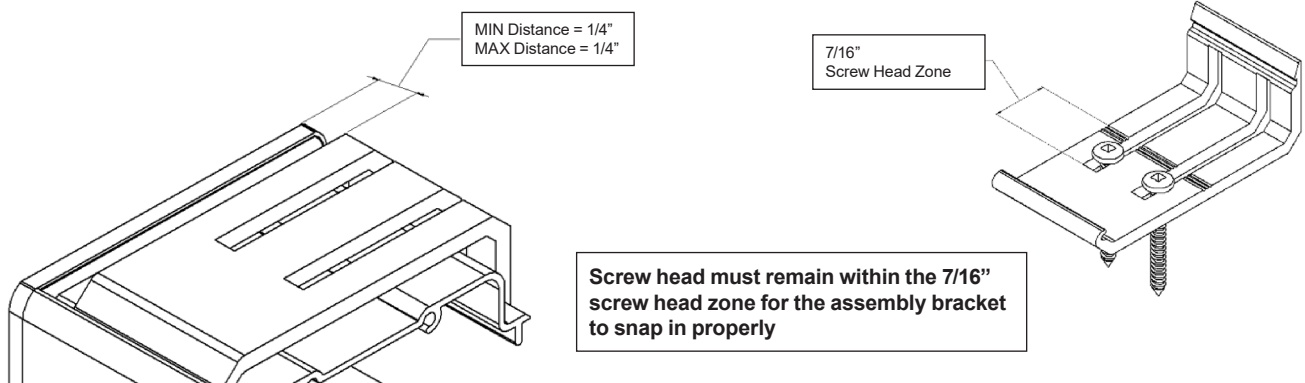

Insert the front edge of the V-102 Assembly Bracket onto the front lip of each V-102 Mounting Bracket, as shown in the diagram below. Starting from one side, push / twist the bracket until the back edge of the V-102 Assembly Bracket snaps into the bottom tab of the V-102 Mounting Bracket. Repeat this process for next bracket.

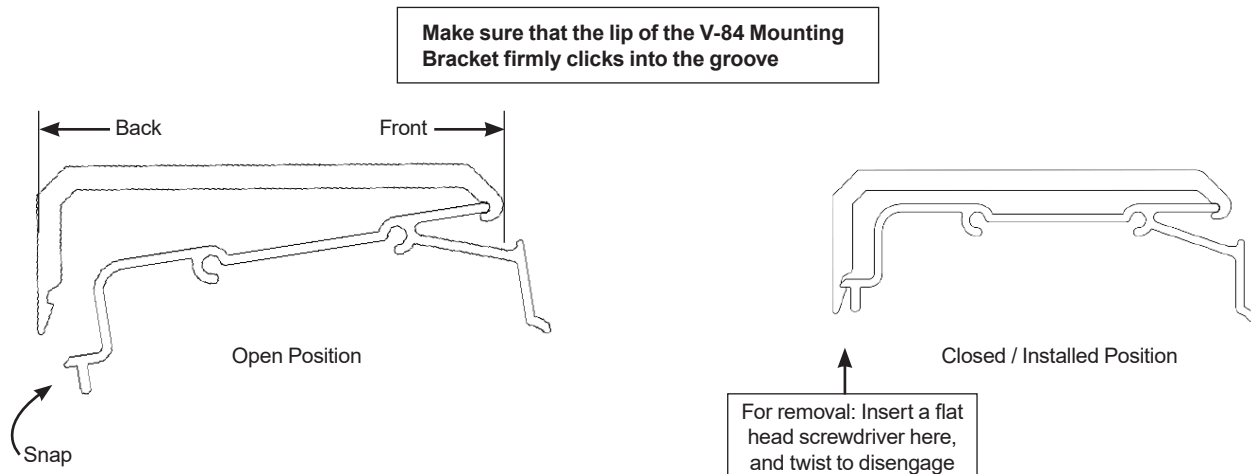

2 INSTALLING THE SPRING BOX

Unwrap the packaged spring box. **Caution:** The box is under tension and should be handled with care.

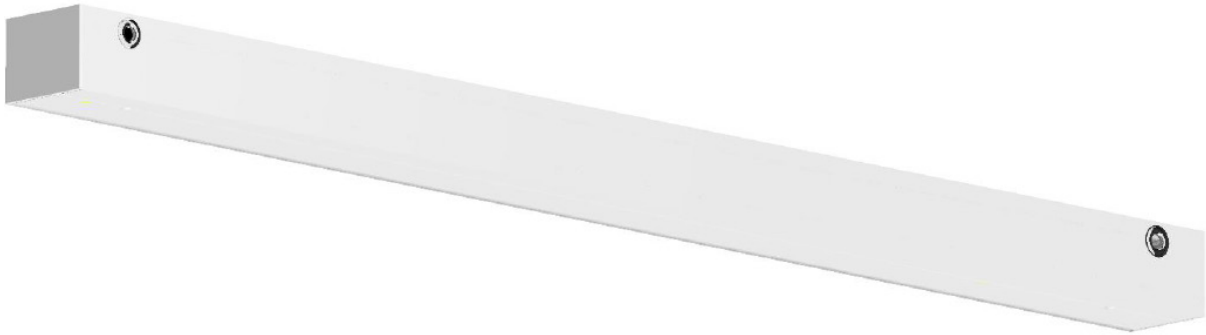

Lay the spring box out on a clean surface and make sure the two 3/16" holes are facing toward you.

Starting at one end pull the cable away from the spring box (approximately 6" to 12") insert the spring locking pin into the 3/16" hole.

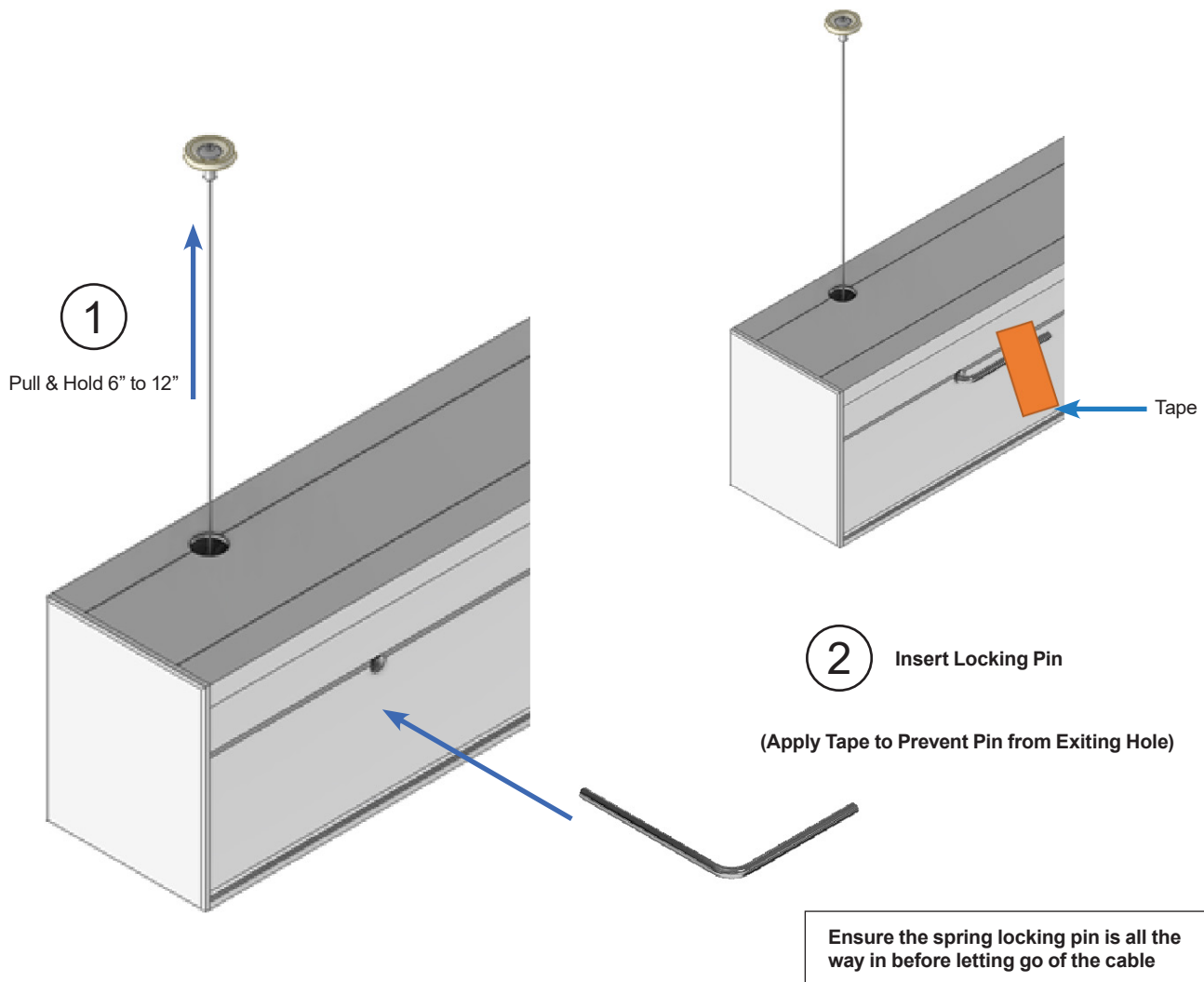

The spring locking pin is meant to take the load of the constant force provided by the springs. Apply the same locking method to the other side of the spring box.

Carefully separate the spring cover at each end to expose the constant tension spring mechanism.

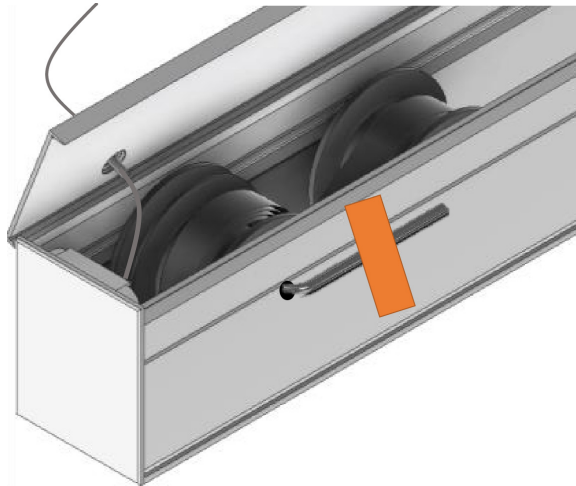

Carefully lift the spring box into the other side of the skylight window frame. The spring box should be installed in a position where the cables are in line and parallel with the fabric.

Secure the spring box to the skylight window frame using the pre-drilled holes approximately 3 – 4 FT spacing inside the spring box. 3/16" hole.

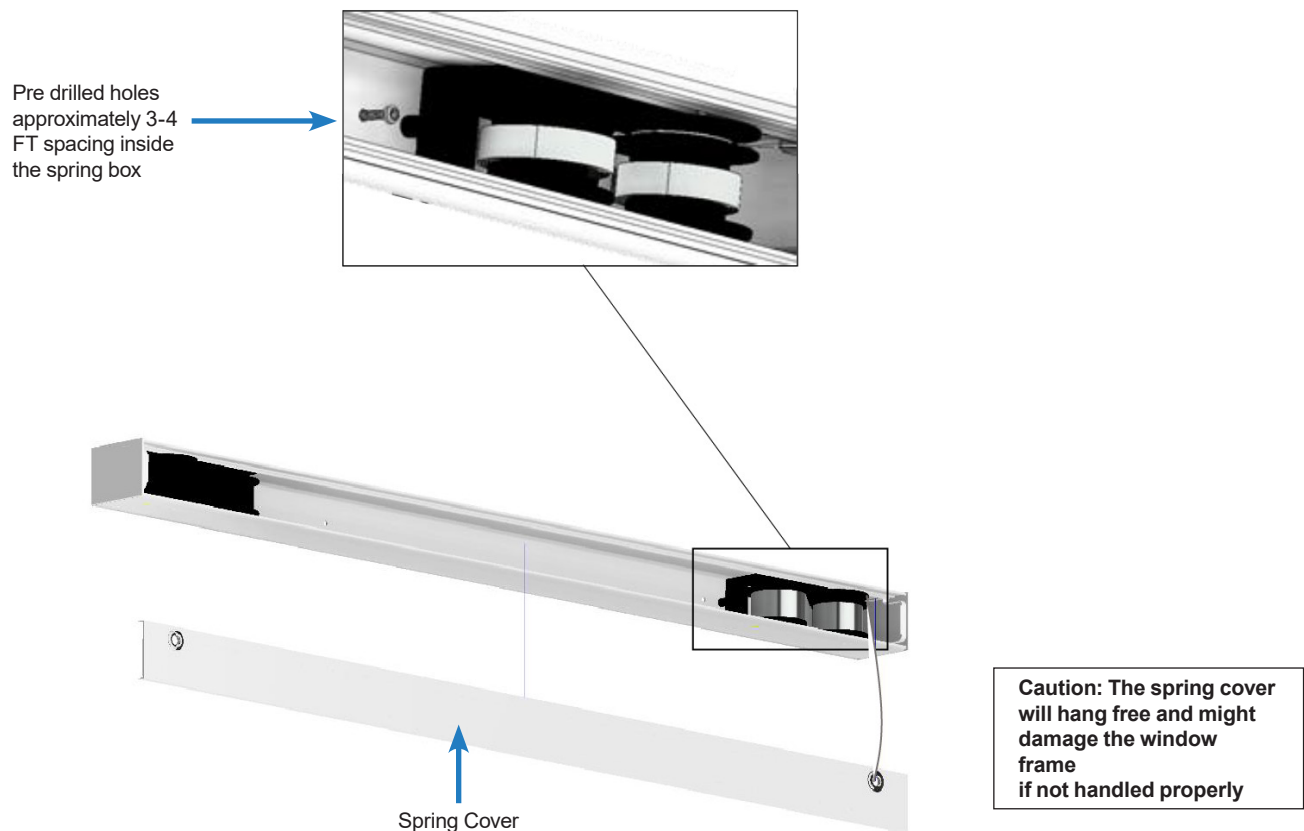

Once finished snap the spring cover back onto the spring box leaving the cables hanging from the spring box.

3 INSTALLING THE GUIDE RAILS

Unwrap the two packaged guide rails and bottom bar guides.

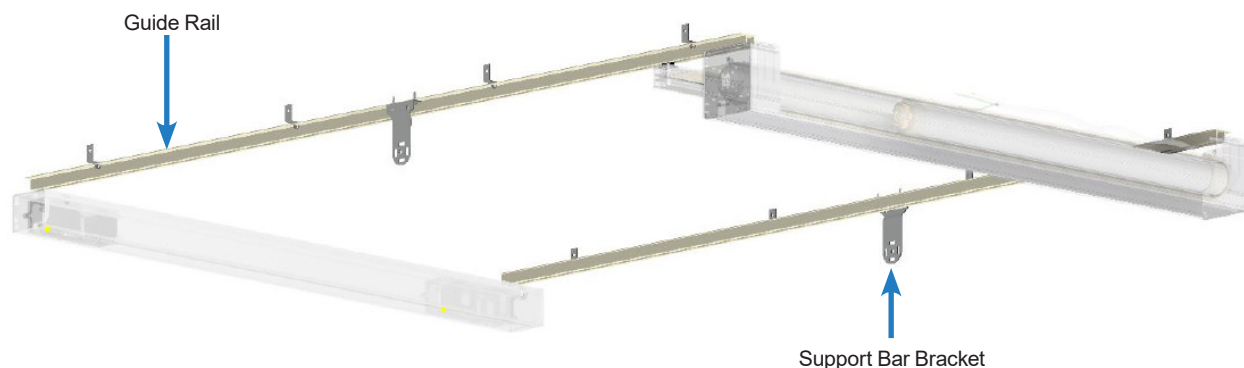

Slide each of the bottom bar guides on either end of the square bottom bar. Starting on one side wall mount the guide rail (L-rail Mounts) inside of the skylight frame. Repeat the process for the other guide rail.

If support bars are required, the support bar brackets must be aligned with one another.

The guide rails can be ceiling mounted if the L-rail mounts are removed

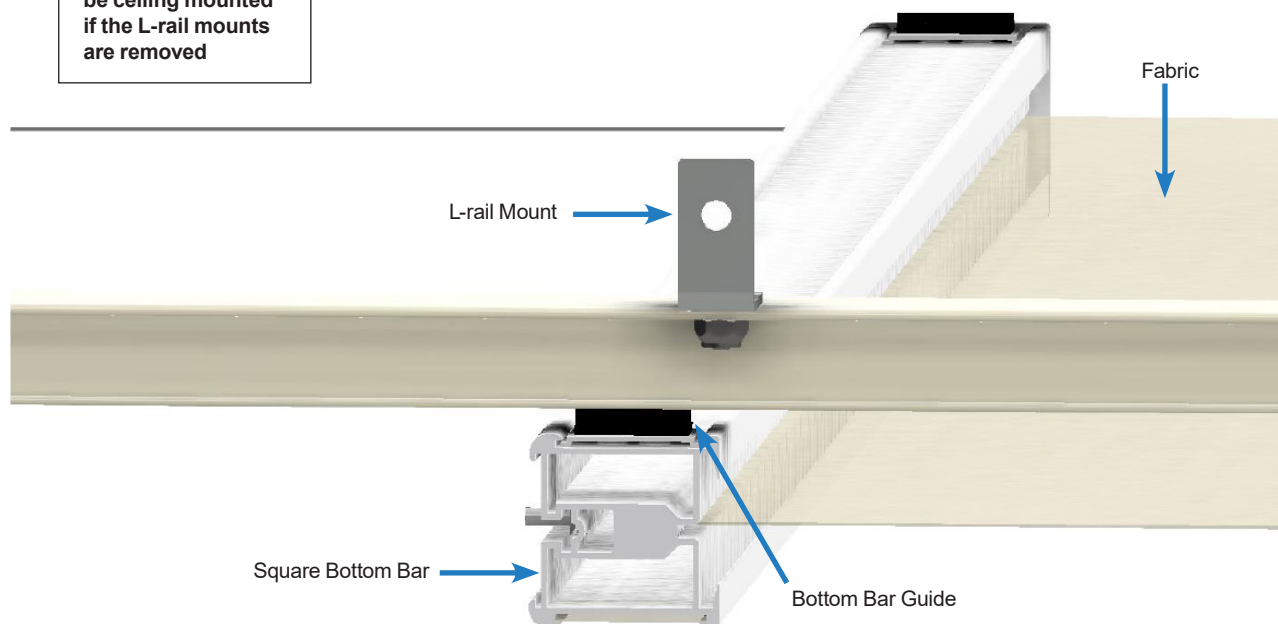

4

ATTACHING THE CABLES TO THE BOTTOM BAR

Starting on one side hold onto the cable and release the spring locking pin. Pull the cable until it can reach the bottom of the fabric. Use the spring locking pin method detailed in STEP 2 each time a new length of cable is pulled out of the spring box. Repeat the process for the other cable.

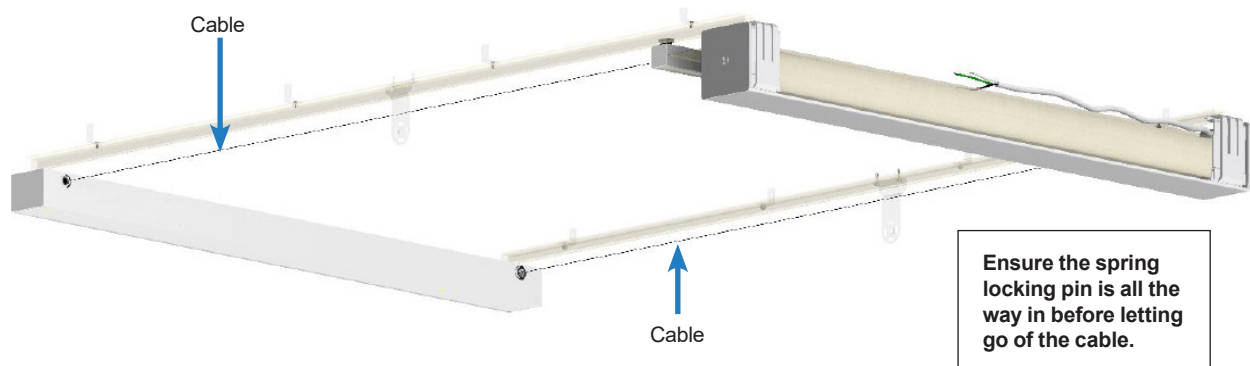

On the end of each cable there is a metal cable connector that is intended to be attached to the square bottom bar. Slide each of the cable connectors into the square bottom bar channel on either side. A plier can be used to help pull the connector through the channel if needed.

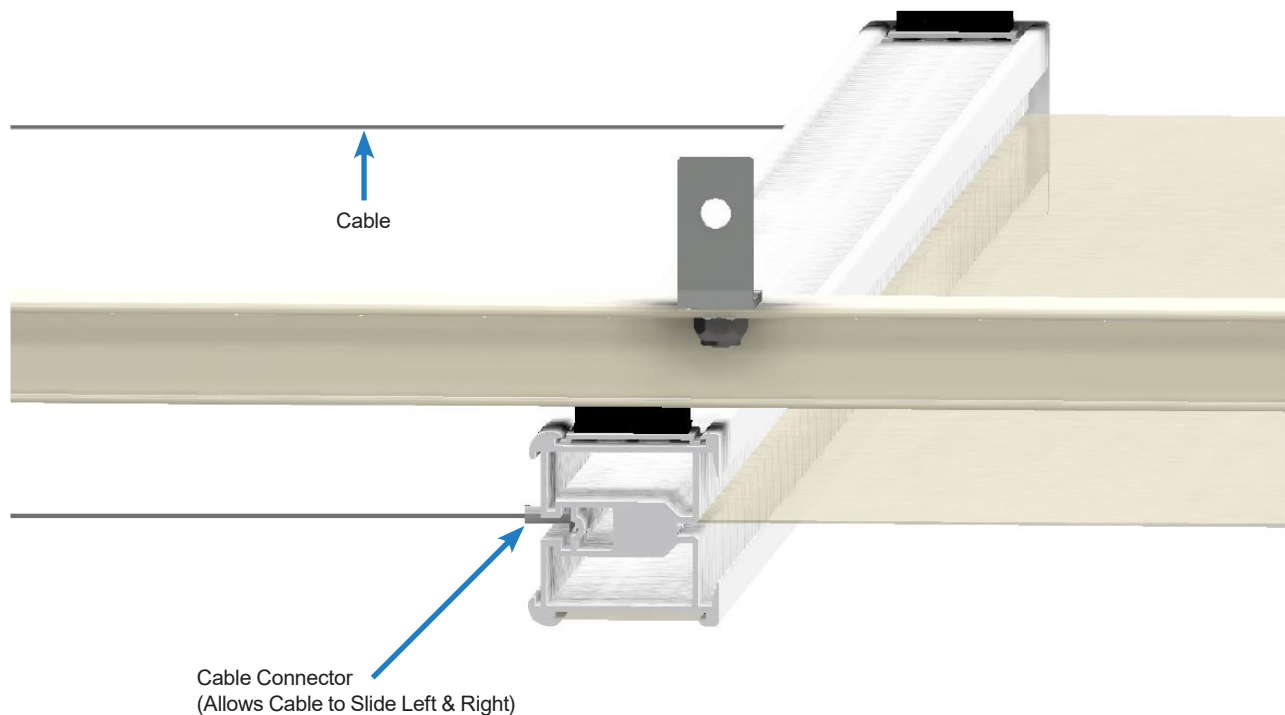

5 PUTTING THE TENSION INTO THE SYSTEM

While holding onto the cable release the spring locking pin, then slowly release the cable.

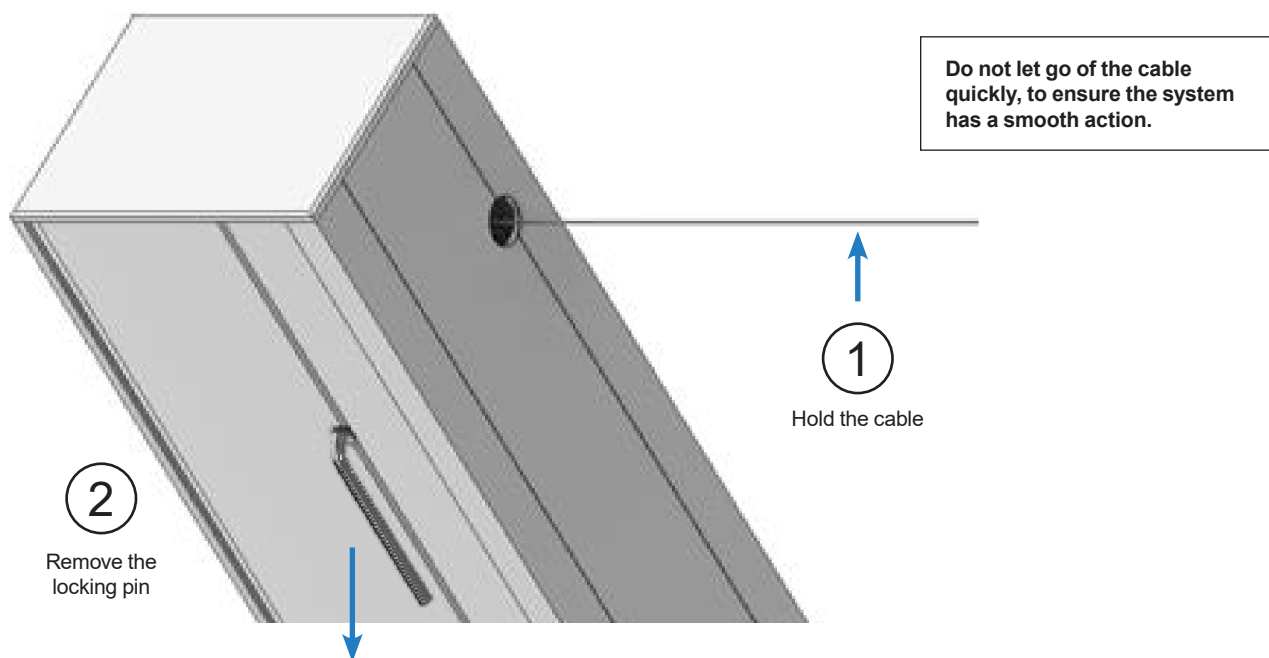

6 CALIBRATING MOVEMENT

Using the motorized instructions provided set up the limits of the shade. Limits can be adjusted later after the movement is correct.

While operating the Nimbus system the cable may need to be shifted left to right to be parallel with window frame.

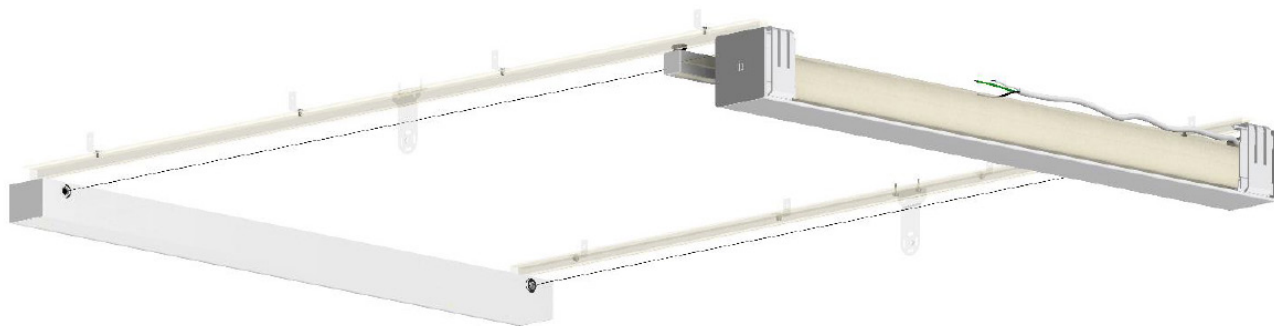

Once the movement looks good, the nylon finishing washer near the cable connector can be cut off. Using the motorized instructions provided adjust the limits of the shade.

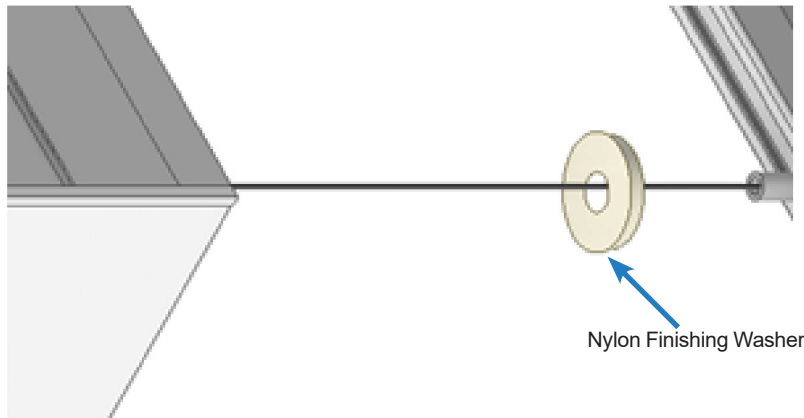

Do not let go of the cable quickly, to ensure the system has a smooth action.

7 INSTALLING THE SUPPORT BAR (OPTIONAL)

Unwrap the packaged support bars. Insert the spring-loaded pin into the support bar bracket hole, then insert the other side into the other support bracket hole.

