

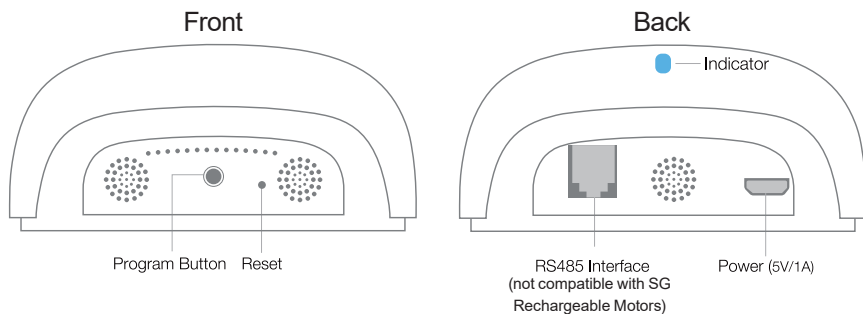

SG Connector Quick Start Guide

1 Plug In the SG Connector

Plug in the power cable and ensure that the SG Connector is on. The indicator light will be solid blue.



2 Download The App

Search for "Connector" in the AppStore or on Google Play.

Download the Connector app:



3 Create an Account By Following the Steps in the App

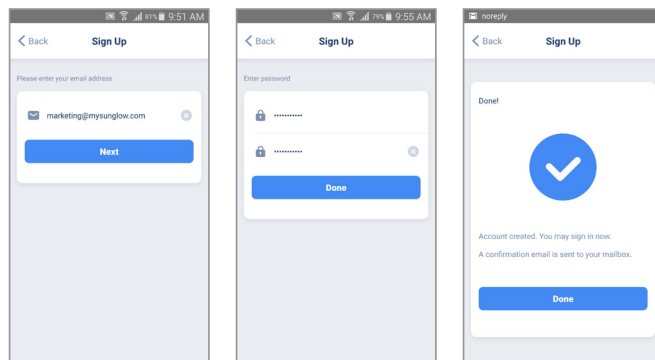

4 Configure the App

See videos on our Youtube channel: <https://goo.gl/jERW44>

5 Connect to a Smart Home Hub

Add your SG Connector to your smart home environment using the Google Home app or the Amazon Alexa app. The SG Connector indicator will glow purple during pairing.

SG Connector can also be used with IFTTT, see their help files: <https://help.ifttt.com/hc/en-us>



Add to Google Home: <https://goo.gl/bjRzK4>



Add to Amazon Alexa: <https://goo.gl/snsYjk>

