

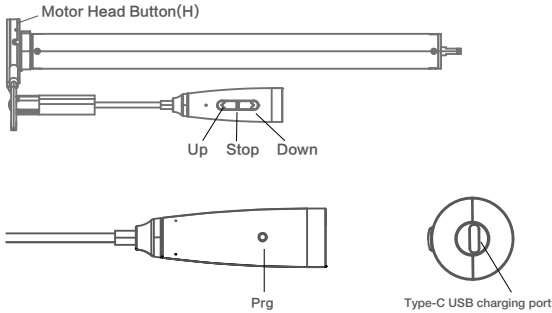

Stealth Wand Programming Instructions

01 Product Info



Working temperature

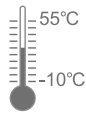

Power Options



5V/2A Type-C USB Charging

02 Caution



1. This product is for indoor use only, do not use outdoor or in humid environments.
2. This motor has built-in rechargeable Li-ion battery pack with integrated charge management. Max input voltage: 5V/2A.
3. Please charge it before using for the first time, make sure it is fully charged before first use. During charging, the blue LED will flicker 3 times every 8 seconds. After fully charged, the blue LED will be always on.
4. When the battery voltage is low, LED will flicker 8 times to give a low-voltage alarm when motor starts.
5. The motor will jog in operation, please do not proceed to the next step until it is complete.
6. During operation, the effective interval of the transmitter button operation is 10 seconds. If there is no effective transmitter operation for more than 10 seconds, it will automatically exit the current mode.
7. Please do not use motor when charging.
8. Upper&Lower limits cannot be set at the same position, limits will be saved even in power off.
9. The motor will run constantly for 6 mins if limits have not been set and no other operation is performed.

03 Instructions

Motor head button (H) functions

Functions	Operation	Jogging time	LED lamp flickers	Note
Sleep Mode, Wand Control Inactive	Hold for 6s	Jog x2	Flicker x2	Hold H button or Prg for 6s, LED flickers twice to show the motor is in sleep mode and wand control is inactive; hold H button or Prg for 2s, it will exit from sleep mode and wand control is active again
Direction Reverse	Hold for 10s	Jog x3	Flicker x3	All settings saved after direction reversed
Reset	Hold for 16s	Jog x4	Flicker x4	All settings deleted

a. Direction Reverse

Correct



If the limits are not set, and direction goes opposite.



If limits are set and direction goes opposite.

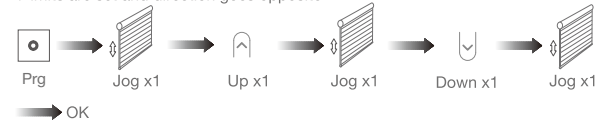

Note: Do reverse the direction when it goes opposite.

b. Upper&Lower Limits Setting

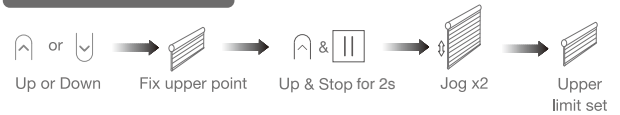

Note: Upper&Lower limits cannot be set at the same point.

Before limits set, the motor will run in one-touch mode by pressing Up or Down, Hold Up or Down for 2s, motor runs in constant-touch mode. Once limits set, press Up or Down, motor runs in constant-touch mode.



c. One-touch/Constant-touch Mode

Constant-touch ----->One-touch



Same operation can toggle from one-touch to constant -touch mode.

Note: When motor is in one-touch mode, hold Up or Down for more than 2s, it will run in constant-touch mode.

d. Setting and Cancelling Favorite Position

Setting

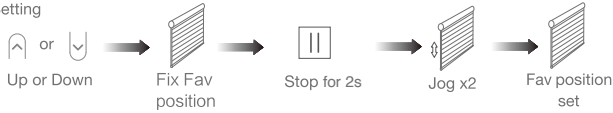

Cancelling



e. Hot key to the Fav. Position

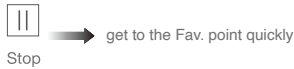

Note: The position set must be after upper&lower limits set.

f. Adjusting Upper & Lower Limits

Adjust Upper limit

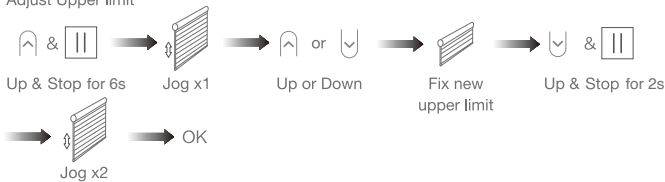

Adjust Lower limit

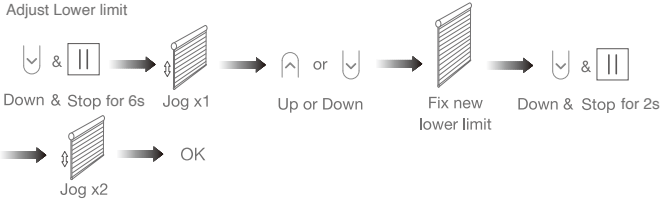

Note: The operation should be done within 4mins.

g. Adjusting Motor Speed

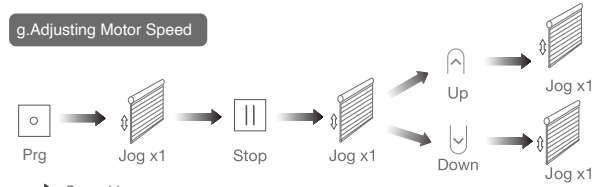

→ Speed increase

→ Speed decrease

Note: If motor doesn't jog, the max/min speed has already been reached. There are 3 adjustable speeds.

h. Position Percent Setting

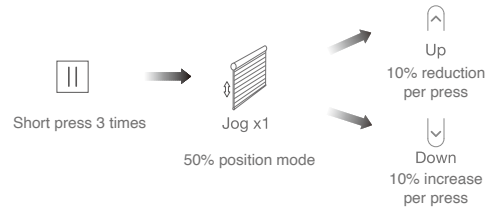

→ After selecting the percentage position, the motor will automatically run to that position after 3 seconds of releasing the button.

Note: Short press Stop button to exit this mode.

04 Troubleshooting

Fault	Cause	Solution
Motor does not work	1.Motor inactive 2.Low battery	1.Hold H button or Prg for 2s to activate motor 2.Charging
Motor stops suddenly	1.Upper & Lower limit set incorrectly 2.Shade exceed rated load 3.Low battery	1.Re-set Upper & Lower limits 2.Adjust load 3.Charging
LED flickers 8 times on motor head when motor starts	Low battery	Charging