

# Neo EZ Pump

## Tension Adjustment Instructions

### ADDING PRE-TENSIONS

Use a #5 ratchet socket to add or remove tension from the shade

To add tension use the following guide:

right side - regular roll: turn counter clockwise

right side - reverse roll: turn clockwise

left side - regular roll: turn clockwise

left side - reverse roll: turn counter clockwise

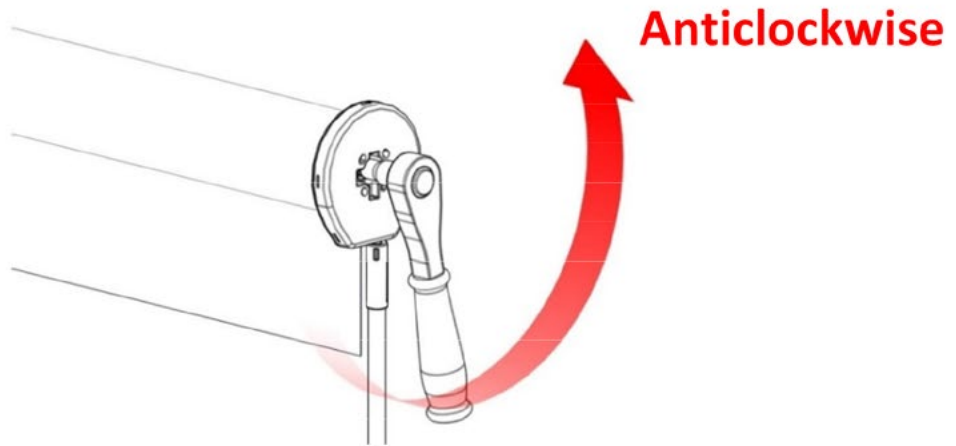

### PRE-TENSION ADJUSTMENT – SHADE REMOVED

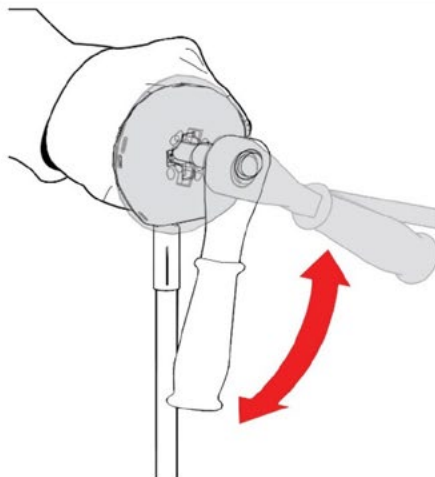

Hold the shade and use the Socket Ratchet to rotate the adjusting shaft (and wand control head) in an anti-clock wise direction enough to release the booster lock. The ratchet will spring back under the spring tension.

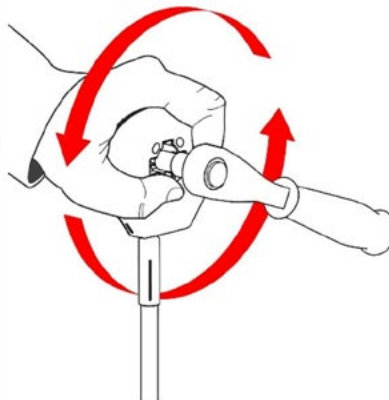

Hold the shade and Wand Control Head together. To add tension, rotate the Socket Ratchet for the number of turns desired in a counter clockwise. (Note, to remove tension allow the spring to unwind in the clockwise direction)

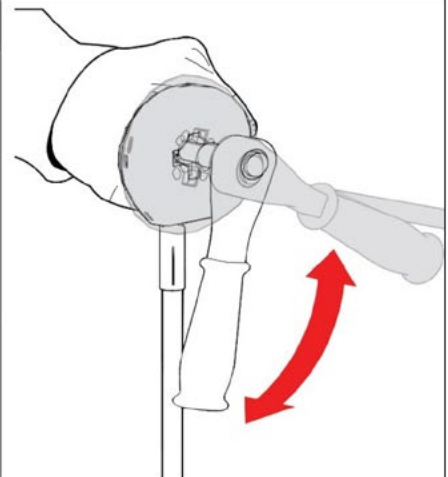

To re-lock the booster and shade, release the wand control and rotate the Socket Ratchet enough to re-engage the lock (approx. ¼ turn). The ratchet should spring back under the spring tension to the locked position.

# Neo EZ Pump

## Upper Limit Adjustment Instructions (note: lower limit not available)

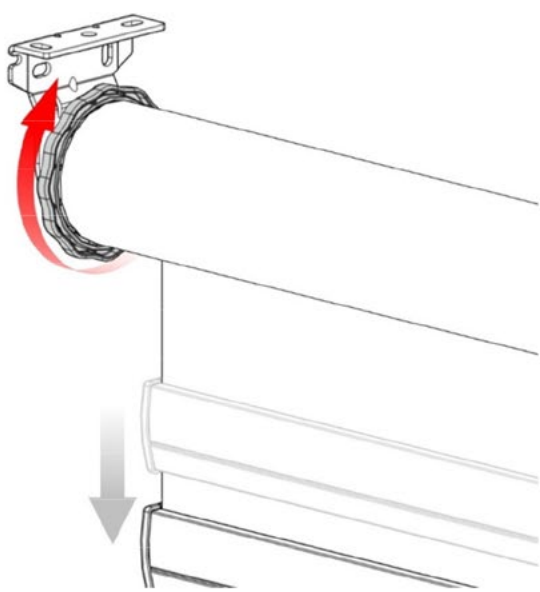
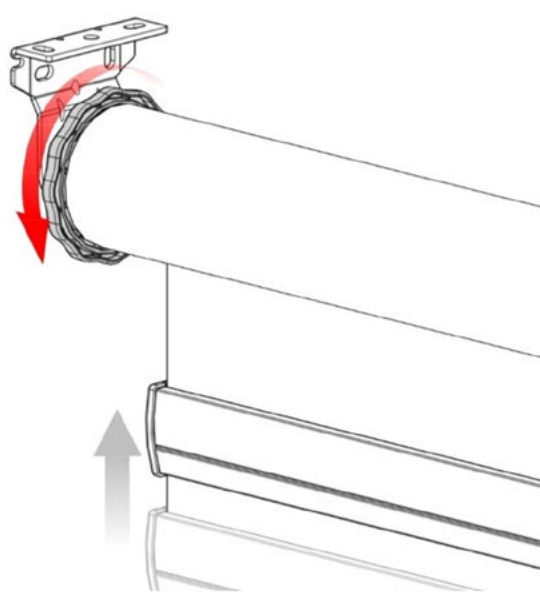
STEP 1 – SET TOP LIMIT	
Ensure Shade is fully raised	
<p>To lower the top limit position rotate limiter head so that the Shade moves down.</p> 	<p>To raise the top limit position rotate limiter head so that the Shade raises.</p> <p>NOTE: The shade must not be locked by the spring to allow the bottom rail to move up. See prior page for unlocking instructions.</p> 
*Standard back roll shown, reverse for front roll	